



AcuCare™ HFNC
High flow nasal cannula



ResMed High Flow Nasal Cannula

The AcuCare HFNC is designed to be fast and intuitive to fit. It can be used for up to 30 days* of home high-flow therapy (HFT).

Quick to fit

The AcuCare HFNC has been designed to be **light and easy to fit** on a wide range of facial profiles*. The stretch fabric on its **dual-strap headgear** can be moved apart to loosen the fit and brought together to make it tighter. It's that simple.

Engineered to stay in place

As well as being **fast to fit**, the AcuCare HFNC is **designed to stay in place** once fitted. The headgear-to-frame combination stabilises the cannula and allows patients to wear it **comfortably for hours** at a time whether they are sitting upright or asleep in bed.

Designed to last

The AcuCare HFNC can be used for up to **30 days** in the home environment. By choosing this durable **nasal cannula** for your home-based patients, you can spend less time replacing and refitting patient interfaces and **reduce waste** by changing the cannula less often.

Key features

- The **innovative dual-strap** headgear sits neatly at the crown of the head.
- The frame is designed to **stabilise the cannula** on the face and suit a wide range of individual facial profiles.
- The prongs provide a contoured fit** in the nostrils and are designed to ensure **patient comfort at different flow rates**.
- This durable interface can be used for up to **30 days**, with fewer interface changes helping to reduce waste and save time.

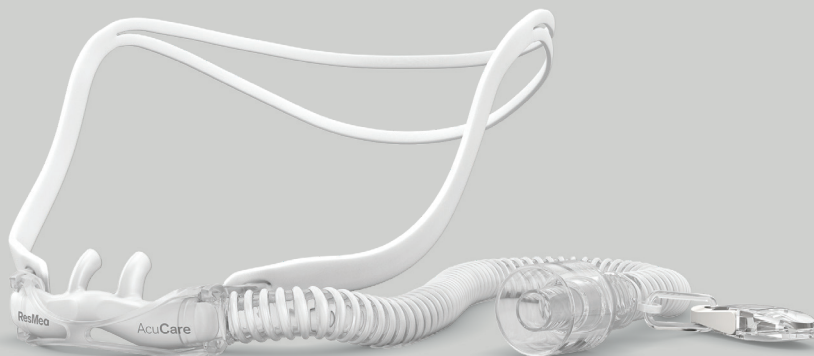

Sizing and fitting guide for AcuCare HFNC



- 1
- Use the sizing template on the packaging to determine the correct cannula size for your patient.
 - Inspect the nasal cannula before use, and replace it if any parts are damaged.

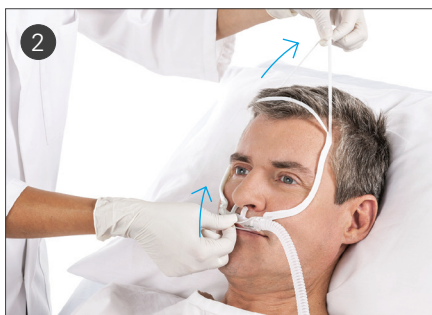

- 2
- Hold the prongs away from the nose.
 - Hold the bottom strap and position it at the back of the head.



- 3
- Position the top strap on the top of the head.
 - Check that the prongs are in the nostrils, but not sealing them.
 - Move the straps apart to loosen and bring them together to tighten.



- 4
- Fix the clip on the end of the short tube to your patient's garment.



- 5
- Connect the cannula to the heated humidification system tubing.

Product codes

AcuCare HFNC - GLO: Small (single pack)	23006
AcuCare HFNC - GLO: Medium (single pack)	23007
AcuCare HFNC - GLO: Large (single pack)	23008

*The AcuCare HFNC is designed for single-patient use by patients weighing >30 kg.

**ResMed D230-135 Danube External Usability Evaluation Report on 30 participants, conducted from 10 August to 1 September 2014. Data on file; ID C164646.

Please refer to the user guide for relevant information related to any warnings and precautions to be considered before and during use of the product.

See ResMed.com for ResMed locations worldwide. AcuCare HFNC is a trademark and/or registered trademark of ResMed. Specifications may change without notice. Product availability may vary across regions.

© 2022 ResMed. 10112856/2 2022-07